

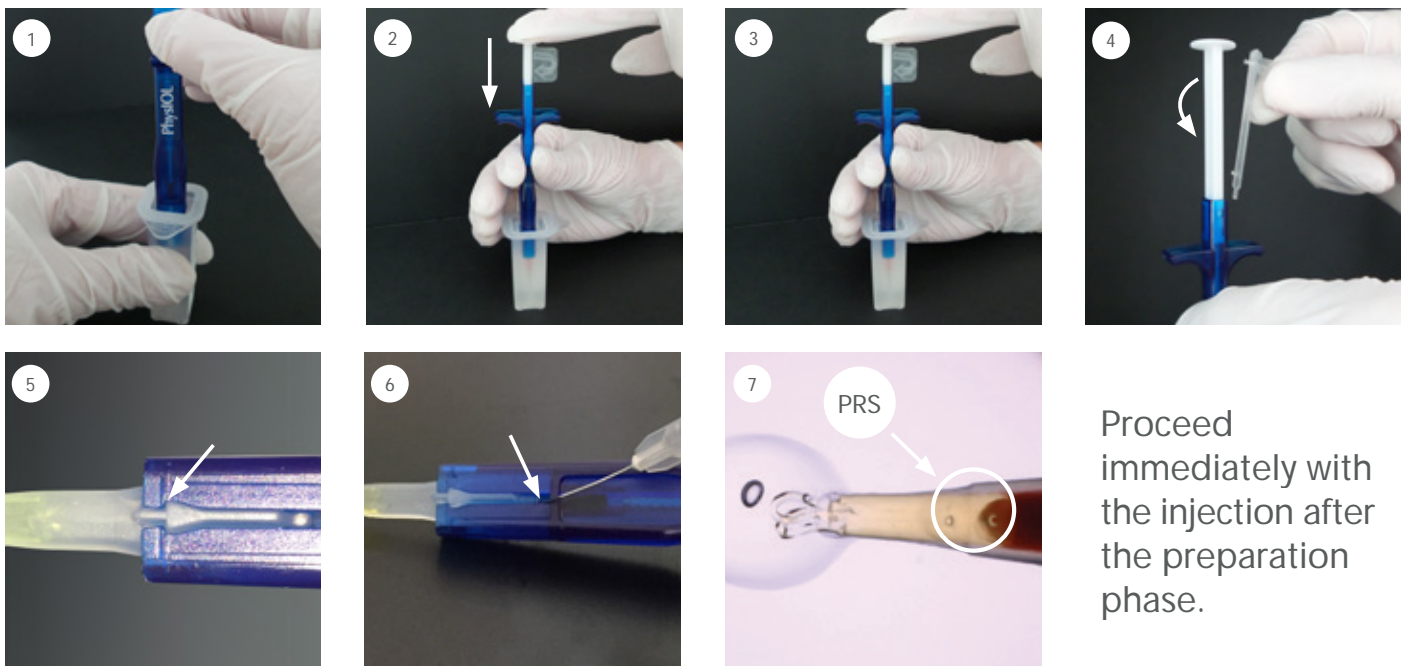

## 1.2.3 Premium injector guidelines with PRS (Pressure Release System)

The MICROPURE 123 and ISOPURE 123 lenses are delivered preloaded in a cartridge, which is simply clipped to the Single-Use Injector 1.2.3. Premium. The Single-Use Injector 1.2.3. Premium requires no lens handling which ensures perfect control of asepsis and makes lens injection comfortable and reproducible. Additionally the unique PRS technology offers an extremely smooth injection in combination with a significant decrease of pressure on the incision.



Proceed immediately with the injection after the preparation phase.

1. Connect the injector vertically onto the preloaded cartridge until you hear the “clip” indicating that both elements have been firmly and adequately locked. If you do not hear the “clip”, there is a possibility that the connection of both elements could not be secured. In the event you do not hear the “clip”, first remove the assembled device from the container. Secondly, vertically place the assembled device into the container and proceed once again to the “clipping”.
2. Push the plunger completely down towards the safety catch and...
3. ... keep the plunger in this position for 3 seconds. This ensures the lens is securely loaded in the cartridge. Then, gently release the plunger.
4. Remove the safety catch by a twist motion.
5. Remove the assembled system from the container and check that the cartridge is properly locked onto the injector. The non-return safety clip of the cartridge should be located just behind both lateral marks of the injector body, as illustrated in the above picture.
6. Rinse the IOL with Balanced Salt Solution (BSS) by introducing the cannula of the Balanced Salt Solution (BSS) syringe into the small hole on the body of the injector, and then inject a generous amount of ophthalmic viscoelastic device (OVD)<sup>1</sup> into the same hole.
7. Push the plunger for injection. When the first two haptics are out of the cartridge, release the plunger a few millimeters to free both posterior haptics, then push again until the implantation.

<sup>1</sup> Take the ophthalmic viscoelastic device (OVD) solution out of the refrigerator at least one hour before use.